

- LEGEND**
- · · · · · — PROPERTY LINE
 - — — — — HIGHEST ANNUAL TIDE (HAT)
 - — — — — MEAN HIGH WATER (MHW)
 - — — — — MEAN LOW WATER (MLW)

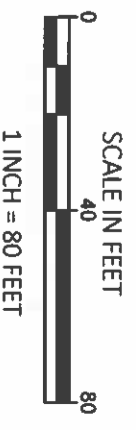

- NOTES:**
- 1) BASE MAP IMAGERY BASED ON MAINE OFFICE OF GIS AFF IMAGERY (2022).
 - 2) 2 FT CONTOUR DATA BASED ON MAINE OFFICE OF GIS TIL 19TD104 and 19TD114.
 - 3) PROPERTY LINE DATA BASED ON PLAN TITLED, "PROPOSED PARCEL ANNEX JENKSROAD, CHEBEAGUE ISLAND, MAINE, PREPARED BY ROYAL RIVER SURVEY COMPANY AND DATE SEPTEMBER 27, 2011.
 - 4) DUNE BOUNDARY BASED ON MAINE GEOLOGICAL SURVEY TITLED "JOHNSON COVE, CHEBEAGUE ISLAND, MAINE AND DATED 2023.
 - 5) PLAN IS FOR PERMITTING PURPOSES.



PROJECT:
 PROPOSED SHORELINE STABILIZATION FOR RENEE NOTTEBOHM, 32 SANDY POINT ROAD, CHEBEAGUE ISLAND, MAINE.

TITLE:
 OVERVIEW OF PROJECT AREA

DRAWN BY: LCV	SHEET: 1 OF 4
CHECKED BY: TAF	
DATE: 8/4/2023	REV DATE: 6/5/2024

Lower Falls Landing
 106 Lafayette Street,
 Suite 2A
 Yarmouth, ME 04096

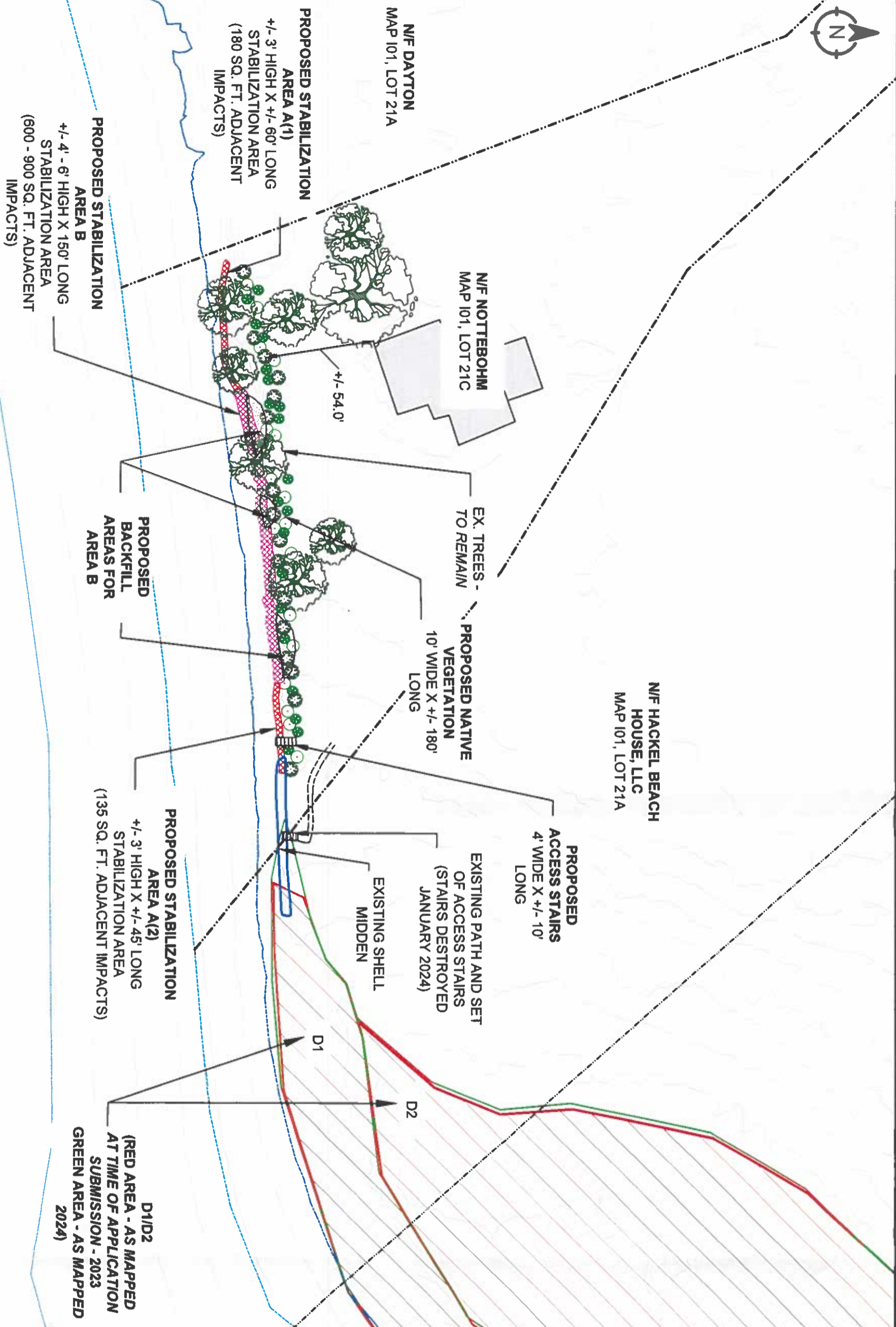
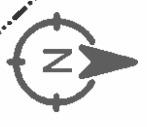

- LEGEND**
- · · · · · — PROPERTY LINE
 - — — — — HIGHEST ANNUAL TIDE (HA1)
 - — — — — MEAN HIGH WATER (MHW)
 - — — — — MEAN LOW WATER (MLW)

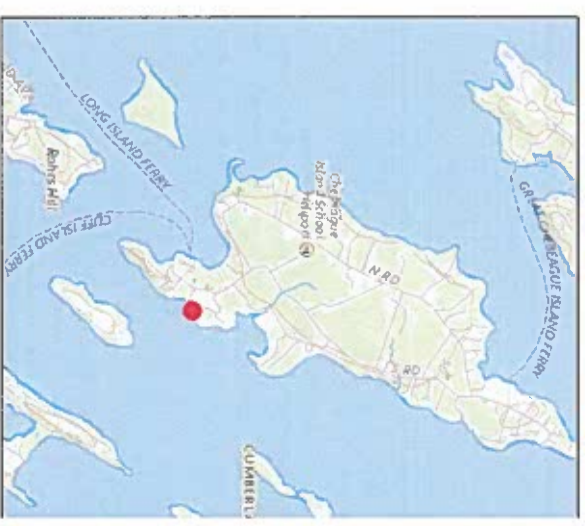

- NOTES:**
- 1) BASE MAP IMAGERY BASED ON MAINE OFFICE OF GIS AERI IMAGERY (2022).
 - 2) 2 FT CONTOUR DATA BASED ON MAINE OFFICE OF GIS TILE 19TD104 and 19TD114.
 - 3) PROPERTY LINE DATA BASED ON PLAN TITLED, "PROPOSED PARCEL ANNEX JENKINSROAD, CHEBEAGUE ISLAND, MAINE," PREPARED BY ROYAL RIVER SURVEY COMPANY AND DATED SEPTEMBER 27, 2011.
 - 4) DUNE BOUNDARY BASED ON MAINE GEOLOGICAL SURVEY TITLED "JOHNSON COVE, CHEBEAGUE ISLAND, MAINE AND DATED 2023.
 - 5) PLAN IS FOR PERMITTING PURPOSES.



PROJECT:
 PROPOSED SHORELINE STABILIZATION FOR RENEE NOTTEBOHM, 32 SANDY POINT ROAD, CHEBEAGUE ISLAND, MAINE.

TITLE:
 OVERVIEW OF PROPOSED STABILIZATIOIC

DRAWN BY: LCV	SHEET: 3 OF 4
CHECKED BY: TAF	
DATE: 8/2/2023	REV DATE: 5/21/2024

Lower Falls Landing
 106 Lafayette Street,
 Suite 2A
 Yarmouth, ME 04096

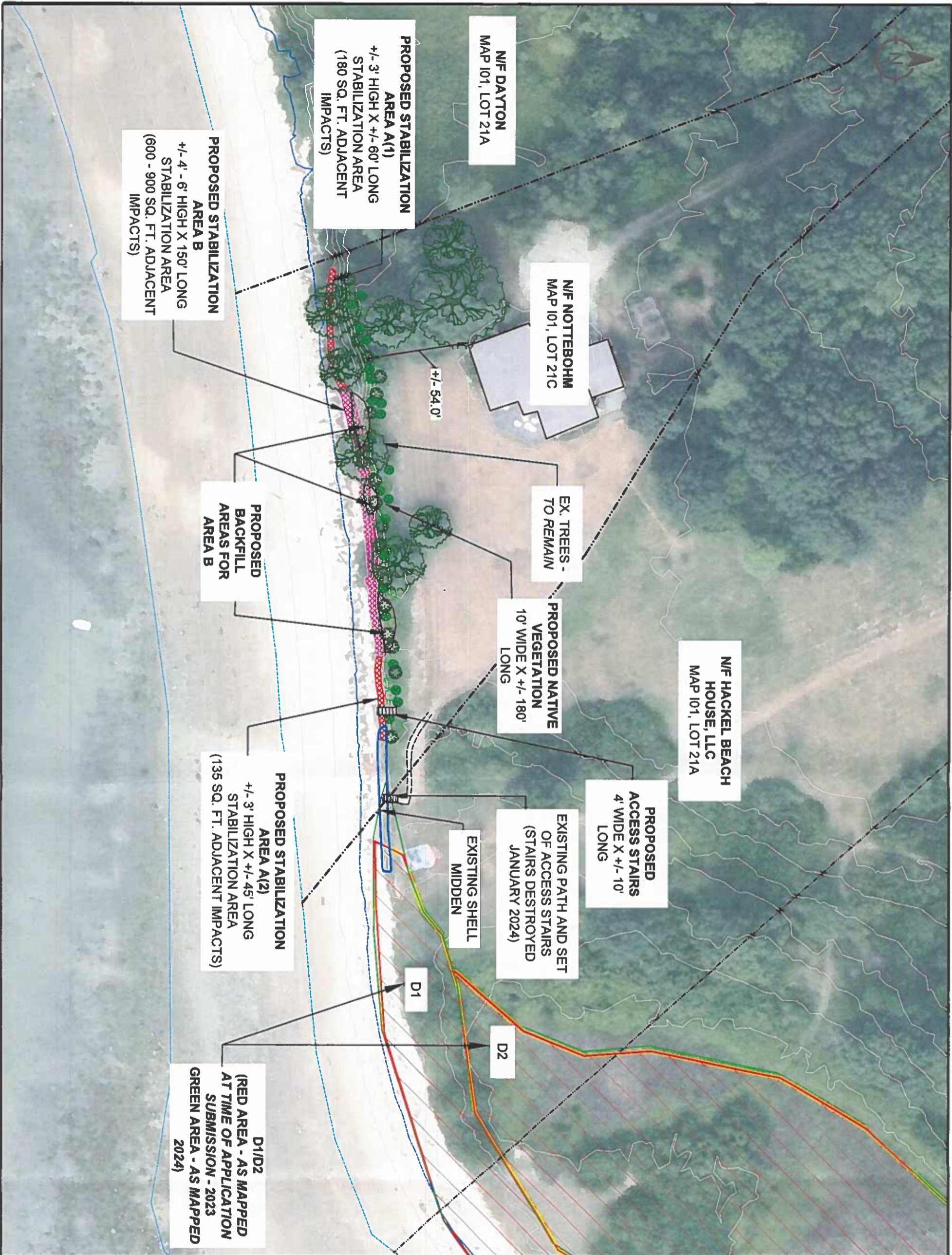

- LEGEND**
- PROPERTY LINE
 - HIGHEST ANNUAL TIDE (HA)
 - MEAN HIGH WATER (MHW)
 - MEAN LOW WATER (MLW)

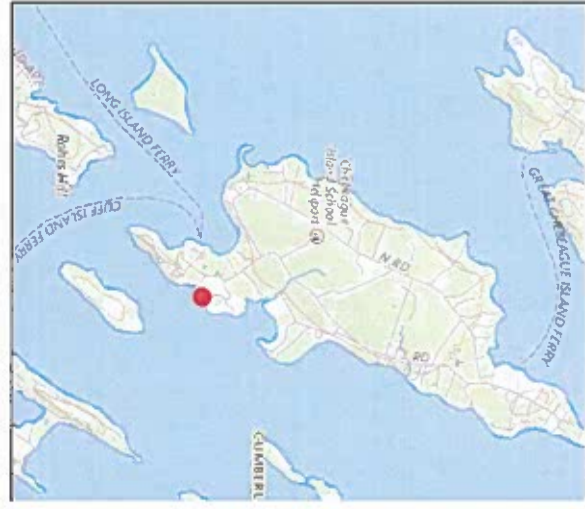

- NOTES:**
- 1) BASE MAP (IMAGERY) BASED ON MAINE OFFICE OF GIS AERI IMAGERY (2022).
 - 2) 2 FT CONTOUR DATA BASED ON MAINE OFFICE OF GIS TILL 19TDJ04 and 19TDJ14.
 - 3) PROPERTY LINE DATA BASED ON PLAN TITLED, "PROPOSED PARCEL ANNEX JENKINS ROAD, CHEBEAGUE ISLAND, MAINE," PREPARED BY ROYAL RIVER SURVEY COMPANY AND DATED SEPTEMBER 27, 2011.
 - 4) DUNE BOUNDARY BASED ON MAINE GEOLOGICAL SURVEY TITLED "JOHNSON COVE, CHEBEAGUE ISLAND, MAINE AND DATED 2023.
 - 5) PLAN IS FOR PERMITTING PURPOSES.

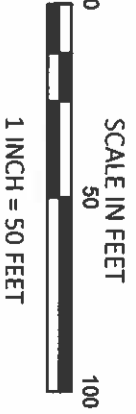

PROJECT:
PROPOSED SHORELINE STABILIZATION FOR RENEE NOTTEBOHM, 32 SANDY POINT ROAD, CHEBEAGUE ISLAND, MAINE.

TITLE:
OVERVIEW OF PROPOSED STABILIZATION

DRAWN BY: LCV	SHEET: 2 OF 4
CHECKED BY: TAF	
DATE: 8/21/2023	REV DATE: 5/21/2024

Lower Falls Landing
106 Lafayette Street,
Suite 2A
Yarmouth, ME 04096

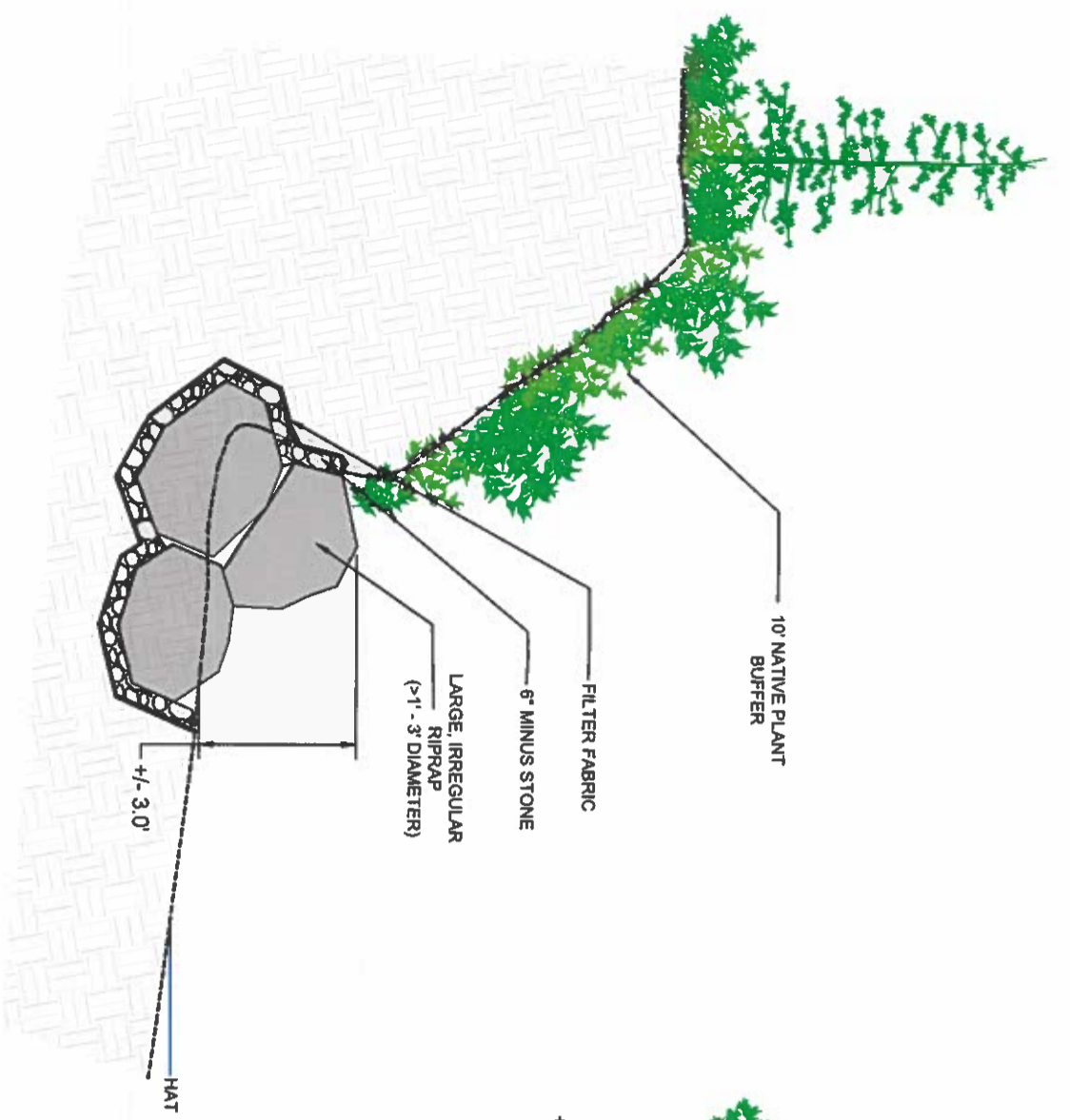

AREA A SECTION

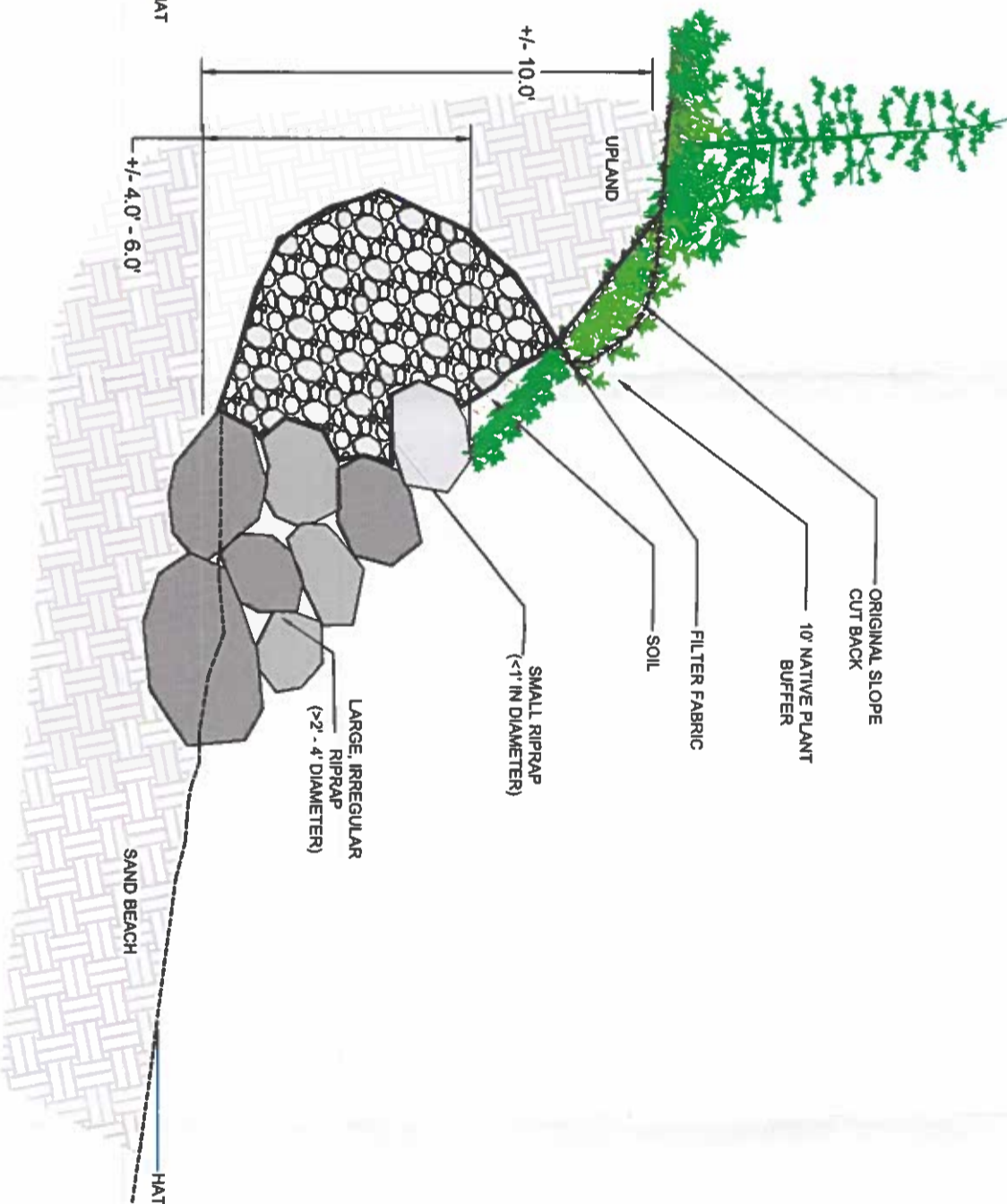

AREA B SECTION

PROPOSED PLANTINGS		
COMMON NAME	SCIENTIFIC NAME	SPACING
BAYBERRY	<i>Myrica pensylvanica</i>	2-3 O.C.
VIRGINIA ROSE	<i>Rosa virginiana</i>	2-3 O.C.
JUNIPER	<i>Juniperus horizontalis</i>	2-3 O.C.

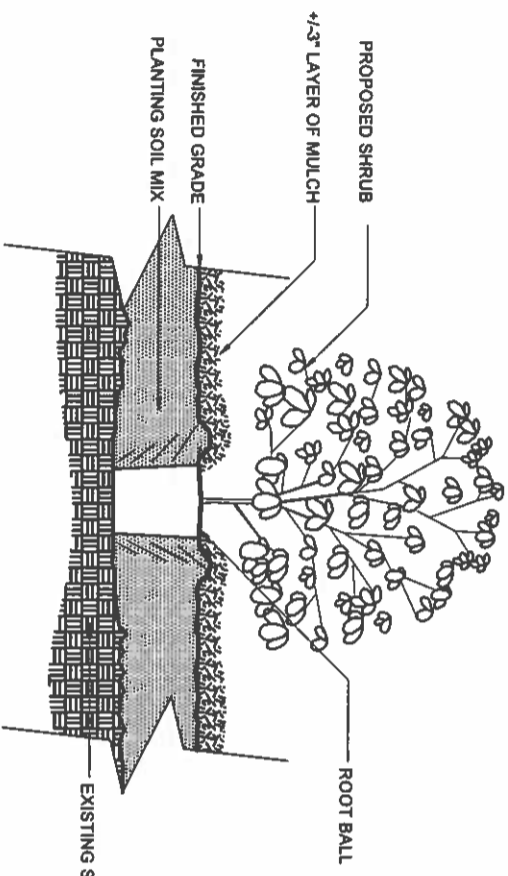

1 SHRUB AND TREE PLANTING
SCALE: N.T.S

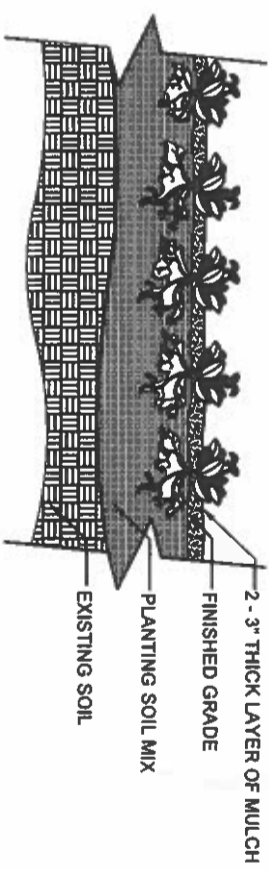

2 GROUNDCOVER PLANTING
SCALE: N.T.S

- NOTES:
- 1) WHERE APPLICABLE, THE FIRST ROW OF RIPRAP WILL BE BURIED IN A TRENCH. BOTTOM STONE WILL BE SET TO A DEPTH OF 1/3 THE STONE'S DIAMETER.
 - 2) RIPRAP WILL CONSIST OF LARGE, IRREGULAR SHAPED ROCKS, FIT INTO PLACE AND/OR PINNED WITH REBAR. RIPRAP IS PLACED ON A SLOPE. SOME VARIATION IN SLOPE, HEIGHT, AND DISTANCE IS UNAVOIDABLE. STONE WILL VARY IN SIZE FROM 2' - 4'.
 - 3) CONTRACTOR WILL HAVE A MAINE DEP EROSION CONTROL CERTIFIED INDIVIDUAL ON-SITE DURING ALL SITE DISTURBANCE.
 - 4) SHELL MIDDEN WILL BE DELINEATED PRIOR TO CONSTRUCTION. NO GRADING WILL BE CONDUCTED IN THIS AREA.
 - 5) EROSION CONTROLS WILL BE ESTABLISHED AS NEEDED AND WILL REMAIN IN PLACE UNTIL SITE IS STABILIZED.
 - 6) PLAN IS FOR PERMITTING PURPOSES ONLY.

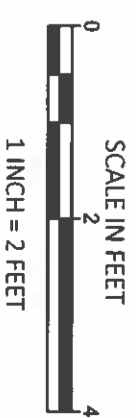

PROJECT:
PROPOSED SHORELINE STABILIZATION FOR RENE NOTTEBOHM, 32 SANDY POINT ROAD, CHEBEAGUE ISLAND, MAINE.

TITLE:
SECTION VIEW OF EXISTING AND PROPOSED CONDITIONS

DRAWN BY: LCV	SHEET: 4 OF 4
CHECKED BY: TAF	
DATE: 8/8/2023	REV DATE: 5/10/2024